

Introduction to Exhibition Space

The Setagaya Art Museum is located in Tokyo's Setagaya region, inside Kinuta Park. Established in 1986, the building is designed by architect Shōzō Uchii, who focused on a design which integrates the building into the park's natural environment. The museum holds the Permanent Collection Galleries, Special Exhibition Galleries, and the Citizens' Galleries. It's a cultural space that combines art, nature, and daily life, displaying a variety of works from masters to local Japanese artists.

We chose the **Setagaya Art Museum Citizens' Gallery B1** as our exhibition space. Through this space, we hope to provide our exhibiting artists an opportunity to be seen, and to invoke thoughts and ideas into our audiences.

Address: Setagaya Art Museum Citizens' Gallery B1, 1-2 Kinutakoen, Setagaya City, Tokyo 157-0075, Japan

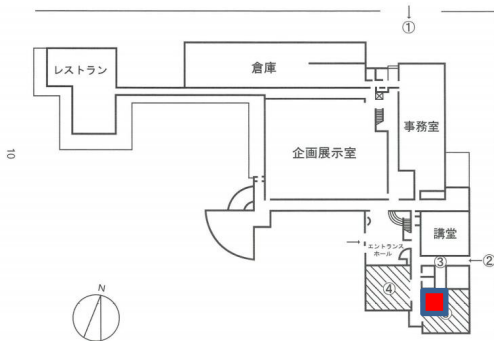

- ①北側通用口 (搬入車両出入口)
- ②区民ギャラリー搬出入口
- ③準備室
- ④区民ギャラリーA
- ⑤区民ギャラリーB

